

 RELEASE NOTES

# Altair Inspire PolyFoam 2021

## New Features and Enhancements

Altair Inspire PolyFoam 2021 includes the following new features and enhancements.

### Material Viewer

A new Materials Viewer has been added to the microdialog for the Nozzle tool that allows you to create or edit existing materials.

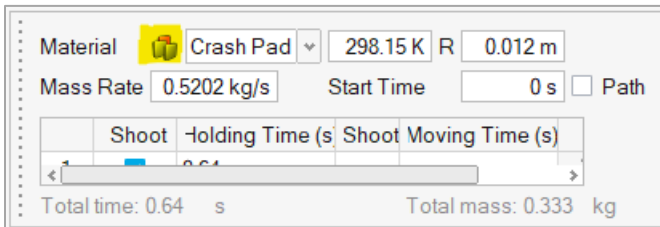

You can use the Materials Viewer to:

- Choose materials for your model from the installed or user-defined materials.
- Customize existing materials from the installed Materials Database and save them locally as new materials.
- Export any installed or user-defined material in .xml file format.

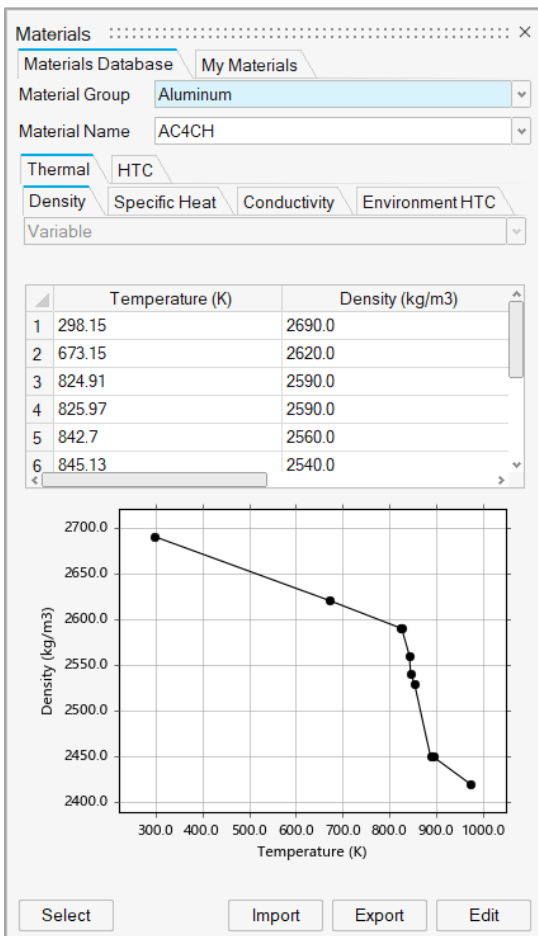

## Import Mold Geometry

You can now import mold geometry from any external CAD data and designate this as a mold part, defining the material and initial temperature.

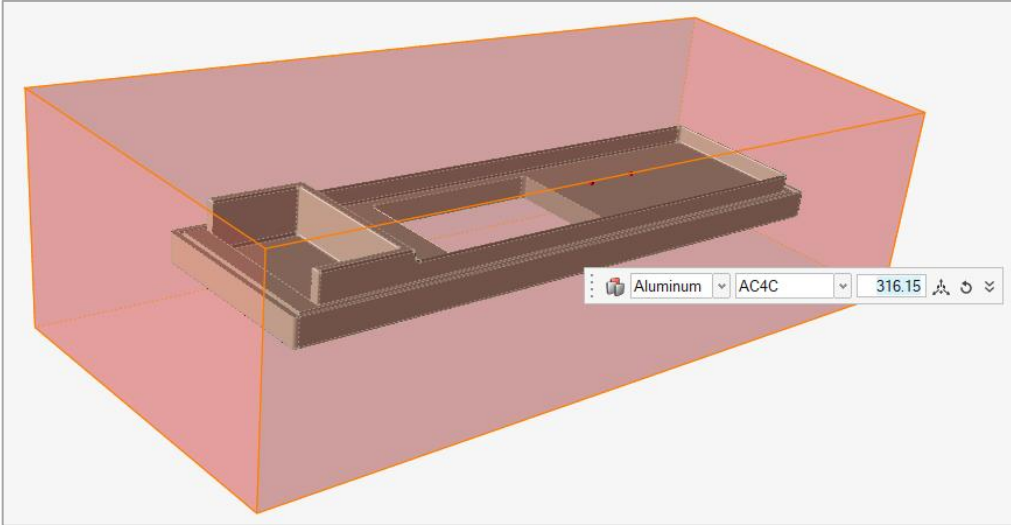

## Square Vents

You can now define vents as either square or circular.

## Resolved Issues

The following issues were resolved in the 2021 release:

- Fixed an issue where clicking Delete while a simulation was running produced an error. [IPFM-381]
- Improved post-processing performance for large models.